

DATE: _____ TYPE: _____

NAME: _____

PROJECT: _____

Durango 399 Series

LED Wall Cutoff Wall Mount

Specifications:

Description:

The Durango 399 Series adds a modern look to any outdoor space. This fixture is ETL Listed and can be used to comply with 2016 Title 24 Part 6 High Efficacy LED Light Source Requirements. The 399 series is designed for wall applications and mounting hardware and

Features:

- ° Bronze Aluminum Housing
- ° Mounting Hardware Included
- ° Clear Acrylic Diffuser
- ° Wall Mount
- ° Minimum Starting Temp -20°F
- ° ETL Listed for Wet Locations

Application:

- ° Outdoor Use Only

Energy Consumption:

- ° 120V, 50/60Hz
- ° Estimated 50,000 Hrs L70
- ° 4000K CCT
- ° 80 CRI

Accessories:

PE - Photocell (120V)

Catalog number:

Family	Lens Color	Base Color	Wattage	Kelvin
399	9 - Clear	3B - Bronze	52 - 52 Watt	40K - 4000K

Images:



Dimensions:

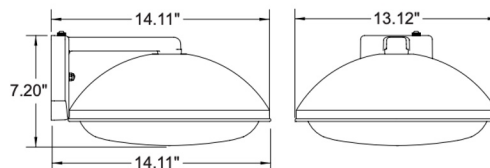

Warranty:

- ° 5 Year Full Unit Warranty

Compliances:

- ° ETL Listed for Wet Location

* Specifications subject to change