

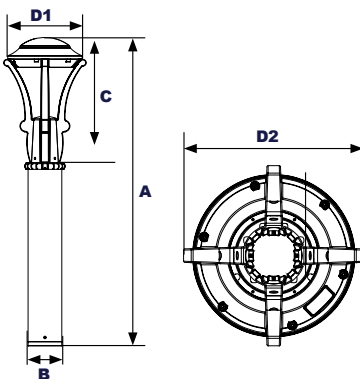

9089AM with Clear Polycarbonate Optical Lens

Dimensions



Diameter 1 (D1)	10 1/2" (264mm)
Diameter 2 (D2)	11 1/2" (294mm)
Height 1 (A)	43" (1093mm)
Height 2 (C)	17 3/4" (441mm)
Base (B)	4 3/4" (120mm)

Project Information:

Project Name: _____	Fixture Type: _____
Complete Catalog #: _____	Date: _____
Comments: _____	

The Incon 9089AM AmberLED Small Valinoti WPB12 Bollard with sealed UV-stabilized clear polycarbonate optical lens is designed for wildlife, dark skies, or security applications requiring monochromatic AMBER light. LEDs operate between 585 and 595 nm, greater than 560nm required for wildlife protection. These fixtures are ideal for retail centers, industrial parks, schools and universities, public transit and airports, office buildings and medical facilities.

Specifications and Features:

Housing:
Extruded and Die Cast with Flush Mounting Base & Vandal-Resistant Screws, Internal Driver Tray for Easy Maintenance.

Listing & Ratings:
ETL: Listed for Wet Locations, ANSI/UL 1598, 8750
IP66 Sealed LED Compartment.

Finish:
Textured Architectural Black Powdercoat Finish Over a Chromate Conversion Coating. Custom Colors Available Upon Request.

Lens:
Full Cutoff IP66 Sealed UV-Stabilized Clear Polycarbonate Optical Vandal-Resistant Lens..

Mounting Options:
Mounting Kit with 8" Zinc-Plated Anchor Bolts, Included.

AmberLED:
Aluminum Boards with Conformal Coating

Wattage:
Array: 19w, System: 21.4w (up to 50w HID equivalent)

Driver:
Electronic Driver, 120-277V, 50/60Hz; Less Than 20% THD and PF>0.90. Standard Internal Surge Protection 2kV. 0-10V Dimming Standard for a Dimming Range of 100% to 10%; Dimming Source Current is 150 Microamps.

Controls:
Fixtures Ordered are Internally Wired for Switching and/or 1-10V Dimming Within the Housing. Remote Direct Wired Interface of 1-10V Dimming is Not Implied and May Not Be Available, Please Consult Factory. Fixtures are Tested with InCon Controls and May Not Function Properly With Controls Supplied By Others. Fixtures are NOT Designed for Use with Line Voltage Dimmers.

Warranty:
5-Year Warranty for -20°C to +40°C Environment.

See Page 4 for Projected Lumen Maintenance Table.

Certification & Listings:





Ordering Guide:

9089AM		1X19	U	AM	C		
Model	Optic	Wattage	Driver	CCT	Lens	Color	Options
9089AM=AmberLED Small Valinoti WPB12 Bollard	B=Type II C=Type III D=Type IV F=Type V	1X19=19w	U=120-277V	AM=1400K	C=Clear UV-Stabilized Polycarbonate Vandal-Resistant Optical Lens	B=Black C=Custom (Consult Factory)	SF=Single Fuse* DF=Double Fuse* SP=Surge Protection (10kV 120-277V) GF1=GFCl Outlet, 15A, 120V S5=Microwave Sensor with Dimming & Remote Programming. See P17125 Spec Page for Details.* BU=Battery Backup,90 Minutes* BUC=Cold Start Battery Backup, -20°C, 90 Minutes* *120-277V Models Only.

Order Information Example: 9089AMF1X19UAMCBSF

Accessories & Replacement Parts:

Mounting Accessories (Order Separately, Field Installed)	Accessories (Order Separately, Field Installed)	Replacement Parts (Order Separately, Field Installed)
<p>BREBASE* Bollard Retrofit Base Kit Adapts New Bollards to Most Existing Bolt Patterns. Fits all InCon Bollards. Die Cast with Powdercoat Finish, Hardware Included. 1 1/2" Dia. x 1 1/2" H</p> <p>*Specify Color: Z=Bronze, B=Black, C=Custom (Consult Factory)</p>  <p>BREBASE* *Shown Mounted</p>	<p>P17126 Remote Programming Tool for P17125</p>  <p>P17126</p>	<p>P17125 Internal Microwave Sensor with Dimming & Remote Programming, 120-277V Only. See P17125 Spec. Page for Details.</p> <p>BOADP1 Adapter Plate with Gaskets for Outlet Boxes. Fits InCon Round Bollards. Die Cast with Bronze Powdercoat Finish.</p> <p>For Replacement Battery Backup, see the InCon LED Battery Backup Specification Sheet.</p>  <p>P17125 BOADP1</p>

Base Dimensions

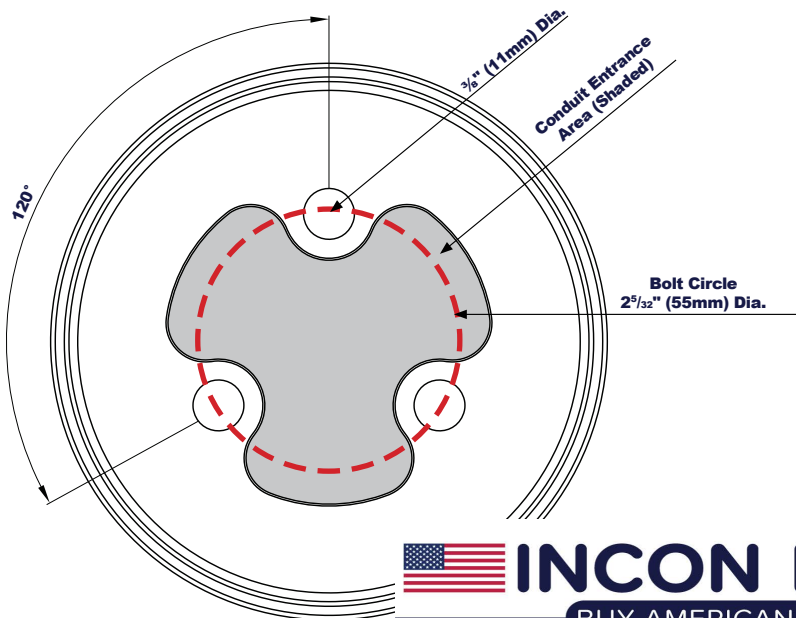

Photometric Data

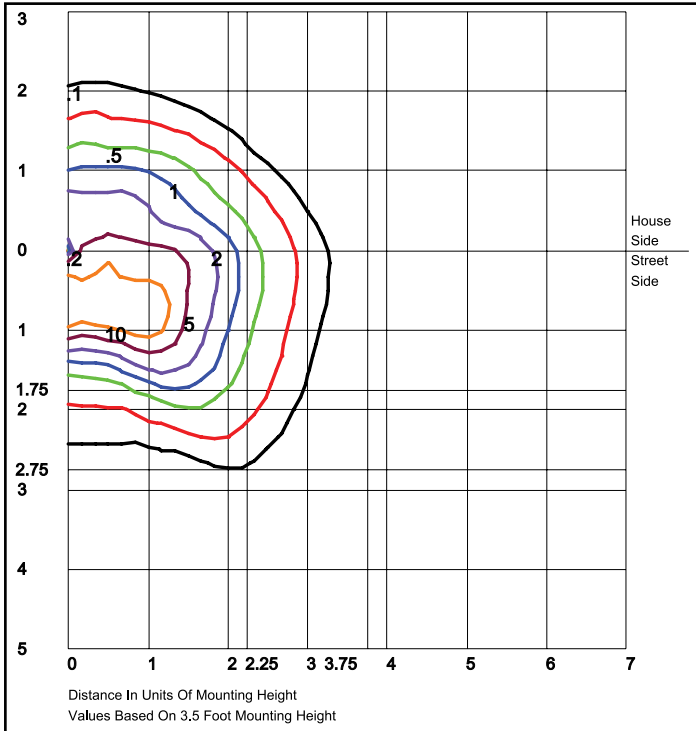

9089AMB1X19UAM
Type II
Grid in feet, Mounting Height = 3.5 ft.

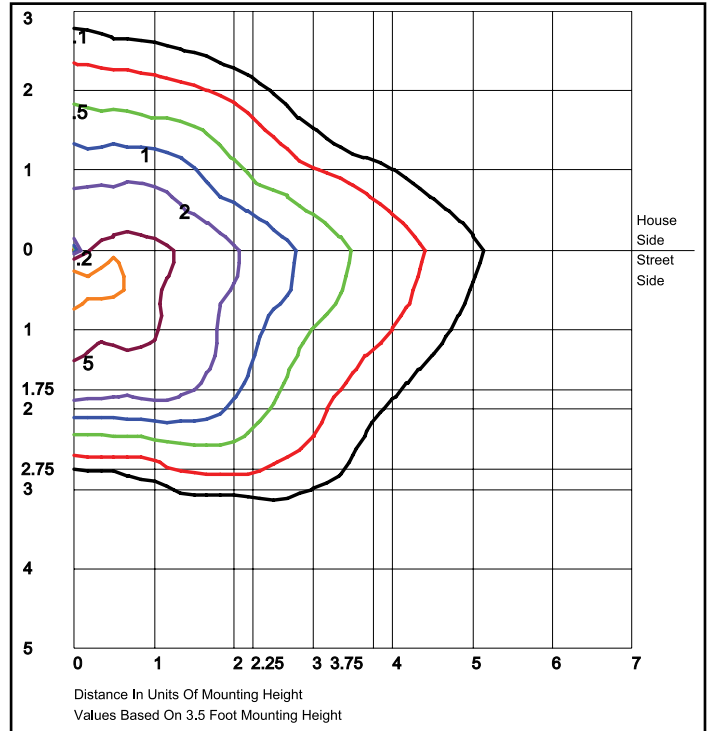

9089AMC1X19UAM
Type III
Grid in feet, Mounting Height = 3.5 ft.

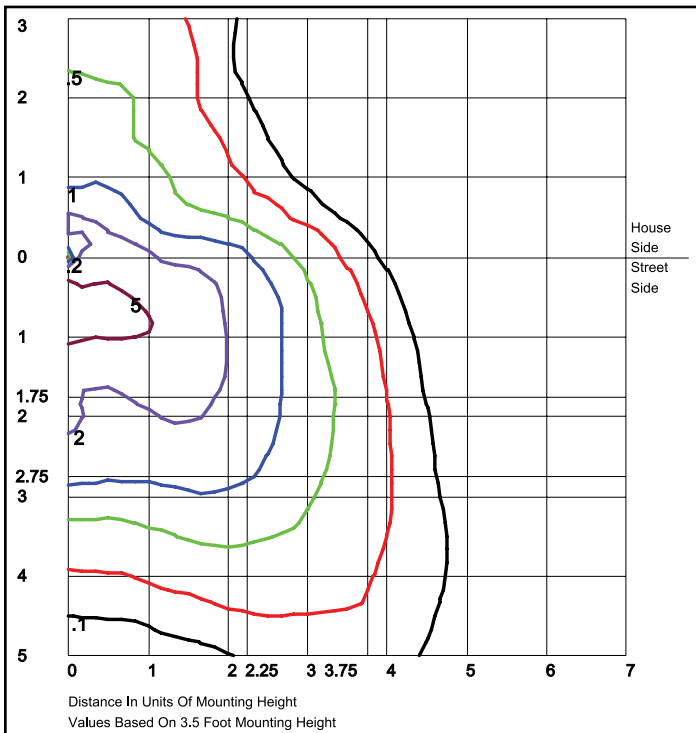

9089AMD1X19UAM
Type IV
Grid in feet, Mounting Height = 3.5 ft.

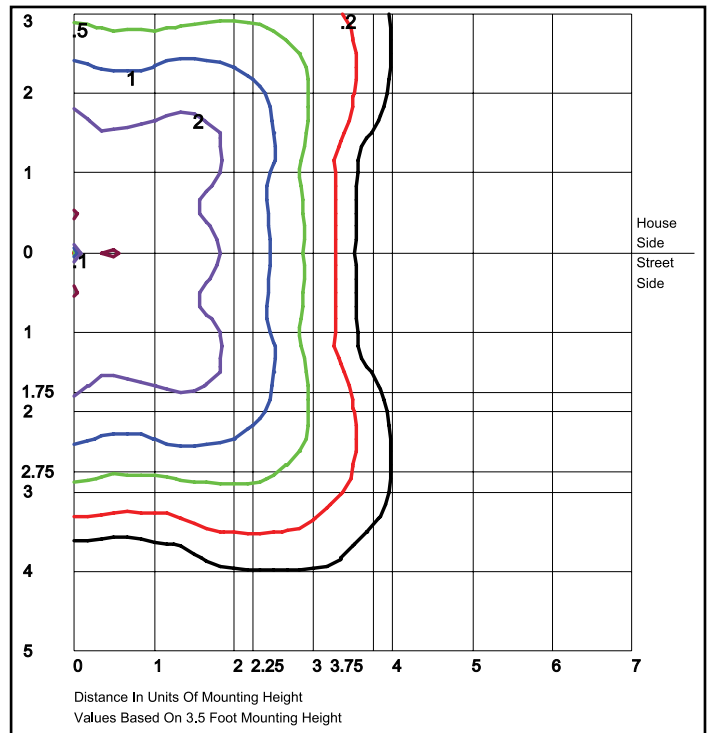

9089AMF1X19UAM
Type V
Grid in feet, Mounting Height = 3.5 ft.

Spectral Chart

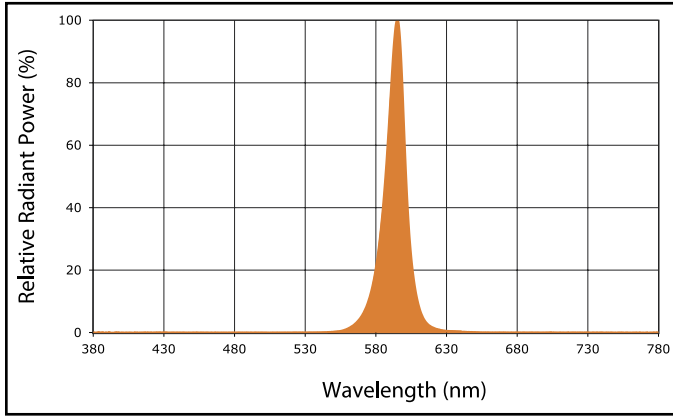

Photometric Performance

	Wattage (Catalog Logic)	19w (1X19)
	Input Watts	21.4w
Optic	CCT	Delivered Lumens
9089AM B=Type II Open	Amber	727
	BUG Rating	B0-U0-G0
9089AM C=Type III Open	Amber	765
	BUG Rating	B0-U0-G0
9089AM D=Type IV Open	Amber	757
	BUG Rating	B0-U0-G1
9089AM F=Type V Open	Amber	801
	BUG Rating	B0-U0-G0

Projected Lumen Maintenance

Data shown for Amber LEDs		Compare to MH				
TM-21-11	Input Watts	Initial	25,000 Hrs	50,000 Hrs	100,000 Hrs	Calculated LED Life
L70 Lumen Maintenance @ 25°C / 77°F	21.4w	1.00	0.96	0.92	0.84	187,000
L70 Lumen Maintenance @ 50°C / 122°F		1.00	0.93	0.87	0.73	113,000
L80 Lumen Maintenance @ 40°C / 104°F		1.00	0.97	0.93	0.86	144,000

NOTES:

1. Projected per IESNA TM-21-11. Data references the extrapolated performance projections for the base model in a 25°C ambient, based on 10,000 hours of LED testing per IESNA LM-80-08.
2. Compare to MH box indicates suggested Light Loss Factor (LLF) to be used when comparing to Metal Halide (MH) systems.